

Application

The SFK-645 formed steel louver is designed for intake and exhaust application where protection against water infiltration is not critical. The SFK-645 is available in a wide array of painted finishes including custom color matching.

Standard Construction

Material: Galvanized steel.

Frame: 6" deep × 20 ga. thick (152 × 1) channel.

Blades: 45° × 20 ga. (1) thick K-style.

Screen: 1/2" × 0.063" (12.7 × 1.6) expanded and flattened aluminum.

Mullion: Visible.

Minimum Size: 12" × 12" (305 × 305)

Maximum Size: Single section: 48" × 96" (1219 × 2438)
 Multiple section: Unlimited

Options

- ☐ Factory finish:
 - ☐ Polyester Powder
 - ☐ Baked Enamel
 - ☐ Prime Coat
- ☐ 1 1/2" (38) flange frame.
- ☐ Welded construction.
- ☐ Alternate bird or insect screens.
- ☐ Insulated or non-insulated blank-off panels.
- ☐ Filter racks.
- ☐ Hinged frame.
- ☐ Heavy duty 16 ga. (1.6) construction.
- ☐ 304 stainless steel construction.

Ratings

Free Area: [48" × 48" (1219 × 1219) unit]: 8.0 ft² (0.74 m²)
 50.0%

Performance @ Beginning Point of Water Penetration

Free Area Velocity: 800 fpm (4.06 m/s)
Air Volume Delivered: 6,400 cfm (3.02 m³/s)
Pressure Loss: 0.09 in.wg. (22 Pa)

Design Load: 30 psf

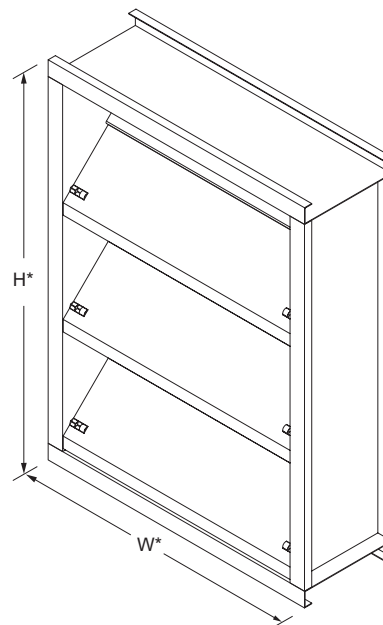

Model **SFK-645**
 (standard)

*Louvers dimensions furnished approximately 1/2" (13) undersize.

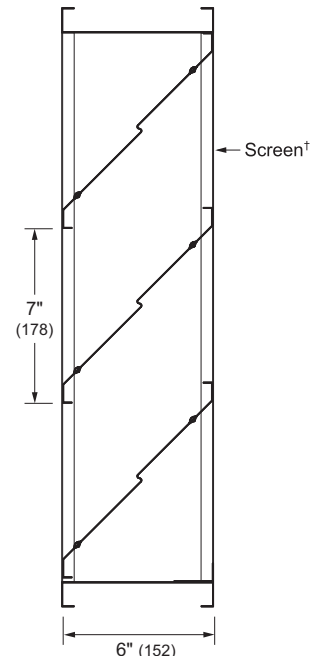

Vertical Section

†Screen adds approximately 3/16" (5) to louver depth.

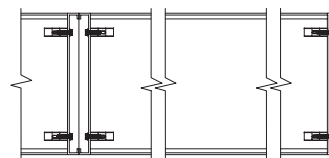

Vertical Mullion
 (standard)

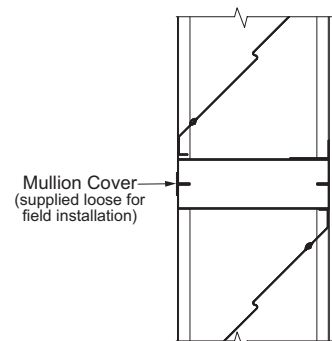

Horizontal Mullion
 (standard)

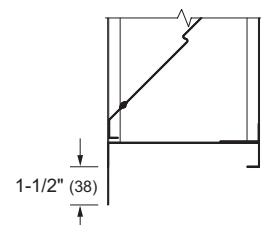

Flange Frame
 (optional)